



Willoughby Elementary School

20766 80 Avenue
Langley, BC V2Y 1X6
Canada

P: 604-888-6033
F: 604-888-9598
<https://willoughby.sd35.bc.ca>

Principal: Mrs. K. Muuren
Vice Principal: Mrs. L. Gray
Admin Assistant: Mrs. M. Bainbridge



Dear Parents/Guardians,

Welcome Back!

We are extremely excited about the upcoming school year. On behalf of the staff at Willoughby Elementary, I am happy to welcome previous and new families to the 2024-25 school year!

We have an exceptional team of educators and a shared focus to support all our students' academic learning and social and emotional well-being. There will be a period of adjustment in the next few days, but our goal remains to get things up and running as quickly and efficiently as possible. We will spend the first few days getting back into the swing of things and reacquainting ourselves with old friends as well as helping our new students and families familiarize themselves with our school and community. We really appreciate your patience and flexibility as we get organized!

We look forward to a productive partnership with you to ensure your children can achieve their highest potential. Parents and caregivers, you play a very important role in the success of our school. We are committed to working with you to create the strongest learning environment for your children. There are many ways for you to be involved in their education and our school. Now is the time to re-establish home routines: proper bedtimes to get plenty of sleep, quiet work and reading time every night, reduced screen time, healthy meals and snacks, and time for active play. Most importantly, practice good handwashing and sneezing/coughing etiquette and keep your children home if they show any symptoms of illness.

A newsletter will be sent out regularly during the school year. Reminders will be sent out frequently to inform you of important dates and events.





Willoughby Elementary School

20766 80 Avenue
Langley, BC V2Y 1X6
Canada

P: 604-888-6033
F: 604-888-9598
<https://willoughby.sd35.bc.ca>

Principal: Mrs. K. Muuren
Vice Principal: Mrs. L. Gray
Admin Assistant: Mrs. M. Bainbridge



Returning Gr. 1 – 5 Students Report to their last year's class on Tuesday, September 3.
New Gr. 1 – 5 Students Report to the Gym on Tuesday, September 3.

FIRST WEEK SCHEDULE

Monday, September 2nd Labour Day students do not attend)

Tuesday, September 3rd (8:45 am – 10:20 am)

- Students return to last year's class (and the teacher) - please line up outside last year's class – Students will be dismissed at these classes **only on Tuesday at 10:20 am**
- **New students** report to the gym; please enter through the front doors and follow the signs - new students will be dismissed from the gym **only on Tuesday at 10:20 am**
- **NEW KINDERGARTEN STUDENTS DO NOT ATTEND**

Wednesday, September 4th (8:45 - 2:33)

- Students go to the class assigned for the week (Sept 4-6) and start grade group rotations. Students will bring a note home on Tuesday indicating where they must be dropped off and picked up for the rest of the week.
- KINDERGARTEN STUDENTS begin gradual entry. See schedule that was sent by email in June and by mail in August.

Thursday, September 5th (8:45 - 2:33)

- Students go to the class assigned for the week (Sept 4-6) and continue with grade group rotations

Friday, September 6th (8:45 - 2:33)

- Students go to the class assigned for the week (Sept 4-6) and continue with grade group rotations
- KINDERGARTEN STUDENTS continue gradual entry (as per the emailed schedule)
- Depending on new registrations, class lists will possibly be finalized by Friday afternoon and families will be notified of class placements.

***** AS CLASSES ARE BASED ON STUDENTS WHO ATTEND DURING THE FIRST WEEK, IT IS IMPORTANT TO LET US KNOW IF YOUR CHILD WILL BE ABSENT**



Willoughby Elementary School

20766 80 Avenue
Langley, BC V2Y 1X6
Canada

P: 604-888-6033
F: 604-888-9598
<https://willoughby.sd35.bc.ca>

Principal: Mrs. K. Muuren
Vice Principal: Mrs. L. Gray
Admin Assistant: Mrs. M. Bainbridge



DURING THIS TIME. PLEASE CONTACT THE OFFICE at 604.888.6033** or email WESattendance@sd35.bc.ca

The map below shows the location of teacher classrooms.

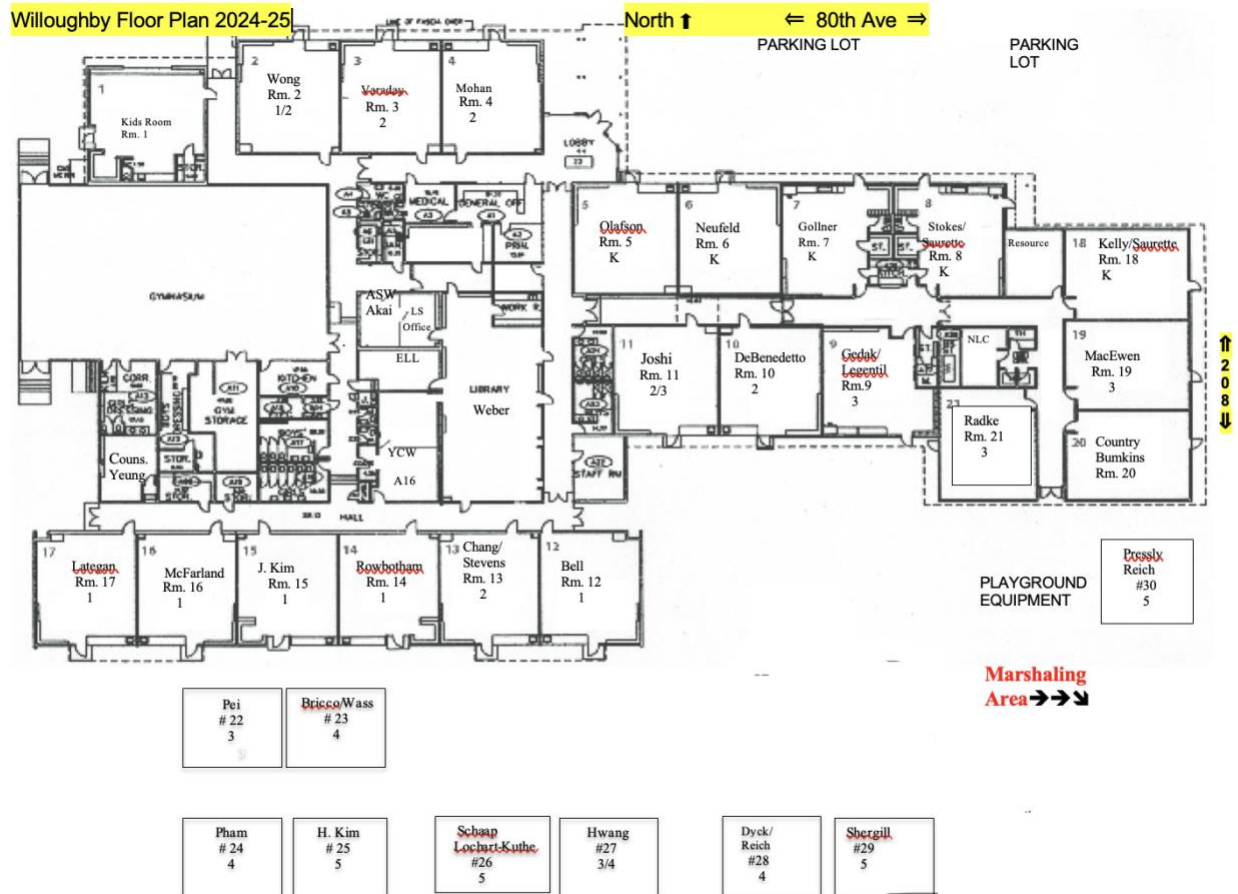

When building class lists, we always take the following criteria into consideration:



- Social compatibility
- Small groups that need to be kept together for instructional purposes
- Leadership style of individual students
- Degree of independence in student work habits
- Integration of special needs students
- Separation of students who do not work well together (if possible)
- Class size and composition



Willoughby Elementary School

20766 80 Avenue
Langley, BC V2Y 1X6
Canada

P: 604-888-6033
F: 604-888-9598
<https://willoughby.sd35.bc.ca>

Principal: Mrs. K. Muuren
Vice Principal: Mrs. L. Gray
Admin Assistant: Mrs. M. Bainbridge



This week we will review the class lists and adjust them as needed to accommodate the movement of families into and out of our school catchment.

SCHOOL SUPPLIES

School Supplies for Grade 1-5 students can be ordered online. If you have not done so yet, you can still order supplies at <https://schoolstart.ca/>

PLEASE DO NOT BRING THE SCHOOL SUPPLIES TO SCHOOL DURING THE FIRST WEEK. STUDENTS CAN BRING SCHOOL SUPPLIES TO SCHOOL AS SOON AS THEY HAVE BEEN PLACED IN THEIR PERMANENT CLASSES.

Kindergarten students are asked to pay a \$50 school supply fee at <https://www.schoolcashionline.com/> Kindergarten families have been provided with student numbers to set up *School Cash Online* accounts included in their *Welcome to K* packages that were mailed out during August. Grade One students can use last year's login. We are asking that all students pay for school supplies online to ensure accuracy and security. If this poses a problem, please contact the school office or your child's classroom teacher.

Please note all school fees will be available for payment online no earlier than Sept 6.

Once classes are finalized, classroom teachers will send out information regarding classroom systems, communication, and organization.



PARKING

Please help make the parking lot safe for our children. Just a few reminders:

- **THE DRIVEWAY IS FOR DROP-OFF ONLY – NO PARKING IS ALLOWED OUT FRONT OF OUR SCHOOL – Our school entry is one-way. CHILDREN SHOULD EXIT VEHICLES QUICKLY AND SAFELY**
- Do not double park cars
- Do not park where yellow lines are painted or on crosswalks
- If you need to park, please park in the church parking lot across from the school and walk your child over to the school at the traffic light – **DO NOT JAYWALK**
- Always drive slowly
- Please do not park in the bus drop off zone. These are designated for buses only
- Do not park in the driving lane (right lane) on 80th Avenue



Willoughby Elementary School

20766 80 Avenue
Langley, BC V2Y 1X6
Canada

P: 604-888-6033
F: 604-888-9598
<https://willoughby.sd35.bc.ca>

Principal: Mrs. K. Muuren
Vice Principal: Mrs. L. Gray
Admin Assistant: Mrs. M. Bainbridge



- Please do NOT block the bus stop on 208 Street – There is no parking allowed before or after the bus stop. RCMP, Bylaw and Traffic Police will enforce traffic rules and issue tickets.

Kind Regards,

Karin Muuren
Principal